

Step Lite Square

Cat. No. SLsq

Cat. No. SLflsq

Cat. No. SLsqLED



Step Lite is designed with a 88mm x 88mm (3½" x 3½") flange for flush mounting into masonry, stone or wood. For illumination of steps and ground level horizontal lighting, for example, across driveways or exterior paved areas. When a canister is used there are no mounting holes in the flange.

A 240 volt 5 watt fluorescent option is available which offers excellent light output, low energy usage and very low heat generation, this changes the luminaire to an IP66 rating .

Ordering Information

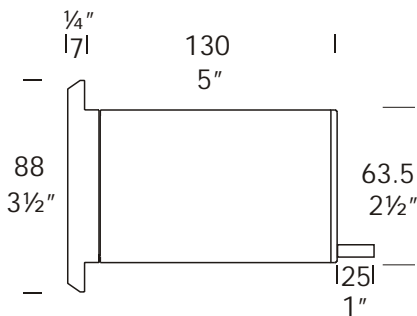
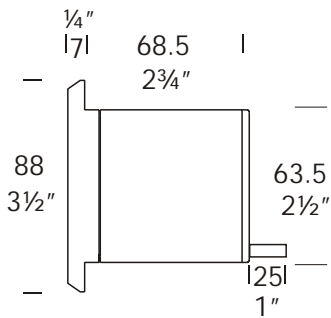

Fluorescent Option

Luminaire Type

SLsq - Step Lite Square

Material/Finish

BK - Black
 BZ - Bronze
 GN - Green
 MS - Metallic Silver
 WH - White

 CP - Copper
 SS - 316 Stainless

Accessories

HCL - Hex Cell Louvre Adaptor
 CJK150 - Cable Joint Kit
 DFL - Frosted Lens
 FL - Fluorescent Option
 LED - LED Array
 LED/T Electronic LED Transformer (installed inside luminaire)
 Canss - 316 Stainless Steel Canister
 Flucan - Fluorescent Canister PVC
 Slcan - Step Lite Canister

Ordering Example: SLsq BZ - Step Lite in bronze powder coat.
 SLflsq SS - Step Lite with Fluorescent Option in 316 Stainless Steel

 HCL BK - Hex Cell Louvre Adaptor in black.
(Accessories ordered separately)



Patent Pending



FACTORY: Ph: 64-9-528 9471 Fax: 64-9-528 9361.
 USA: Ph. 310 560 7310 Fax. 1 877 692 4589.
 hunza@hunza.co.nz www.hunza.co.nz
 Specifications may change without notice.

130 Felton Matthew Ave, Glen Innes, Auckland, New Zealand.
 3237 Long Island St, W. Sacramento, California 95691, USA.
 Manufactured in New Zealand.

© 2003 Hunza Holdings Ltd

Luminaire Construction

CNC machined from one of the following metals:

High corrosion resistant 63.5mm (2½") x 10mm (25/64") aluminium.
End cap - solid aluminium 63.5mm (2½") rod, flange 90mm x 90mm (3½" x 3½") solid aluminium bar with chromate substrate and high UV resistant polyester powder coat -

Colours Black, Bronze, Green, Metallic Silver, White.

Copper: 63.5mm (2½") x 10.5mm (13/32"). End cap - solid copper 63.5mm (2½") rod.

Flange 90mm x 90mm (3½" x 3½") solid copper bar.

316 Stainless steel: 9mm (11/32"). End cap - solid 316 stainless steel 63.5mm (2½") bar.

Flange 90mm x 90mm (3½" x 3½") solid 316 stainless steel bar.

Mounting

Designed to fit through a 66mm (2 5/8") hole and be fixed into position by two screws in the flange or a Step Lite canister (see accessories) can be used which maintains the aesthetic look of the flange by eliminating the two screw holes in the flange.

Features

Lens:

3mm (1/8") thick clear tempered shatter resistant glass.
Life Time Warranty.

Gaskets:

Silicone, iron impregnated 220°C (428°F).

Lamp Holders:

GU5.3 - 350°C (662°F) ceramic multi contact lamp holder with 250°C (480°F) teflon cables.

Fluorescent

E27 PET 210° (410°F) base mount.

Accessories:

Cable Joint Kit (Cat. CJK 50)
Not approved for USA /Canada.

Frosted Lens (Cat. DFL).

Fluorescent Canister, PVC (Cat. Fican).

Fluorescent Option 5 watt 240 volt (Cat. FL) IP66.

Hex Cell Louvre Adaptor (Cat. HCL).

LED Array (Cat. LED). Red, Green, Blue, Yellow and White.

LED Electronic Transformer 100 - 240volt 6va. for inside the luminaire (Cat /TLED).

Step Canister (Cat. Sican).

316 Stainless Canister for use in lime stone etc. (Cat. Canss).

Standards

IP66 / IP68  UL1838

Luminaire Weight

12 volt:

Alum .490kg (1lb)
Cop 1.415kg (2lb 15oz)
SS 1.055kg (2lb 5oz)

Fluorescent: IP66

Alum .805kg (1lb 12oz)
Cop 2.350kg (5lb 2oz)
SS 1.790kg (3lb 15oz)

Power Supply

HUNZA® Inground or Wall Mount
Transformer: not included.
HUNZA® H20/24LED: not included.
HUNZA® IG20/24LED: not included.
Electronic transformer 100 - 240 volt 50/60Hz. 24 volt d.c. 6va: not included.

USA and Canada:

HUNZA® Wall Mount Transformer: not included.
Electronic transformer 100 - 240 volt 50/60Hz. 24 volt d.c. 6va: not included.

Luminaire: supplied with Halogen

MR16 GU5.3 20 watt lamp max.

Fluorescent

E27 - 240 volt 5 watt self ballasted lamp.

LED

LED Array 24 volt d.c. 1.2 watt.

USA and Canada:

MR16 GU5.3 20 watt lamp max.

LED

LED Array 24 volt d.c. 1.2 watt.

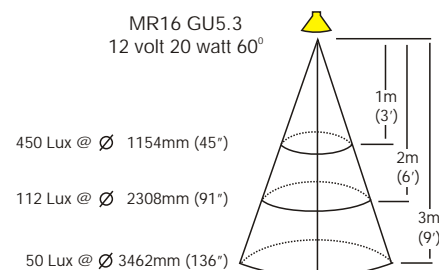
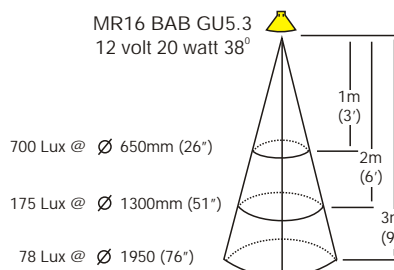
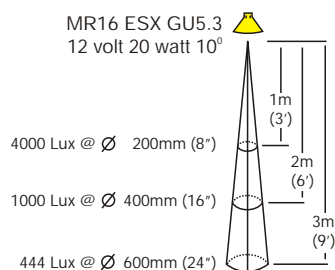

FACTORY: Ph: 64-9-528 9471 Fax: 64-9-528 9361.
USA: Ph. 310 560 7310 Fax. 1 877 692 4589.
hunza@hunza.co.nz www.hunza.co.nz
Specifications may change without notice.

130 Felton Matthew Ave, Glen Innes, Auckland, New Zealand.
3237 Long Island St, W. Sacramento, California 95691, USA.
Manufactured in New Zealand.

© 2003 Hunza Holdings Ltd